



ORAL FLUID DRUG TEST

T-CUBE[®]

Fast and convenient oral fluid drug detection for employment and insurance testing

- 5-10 drug configurations available for a fully customized oral fluid testing program
- Saliva saturation indicator ensures sufficient specimen volume is collected
- Eliminates need for gender-specific observation and limits adulteration and tampering
- Drug test results at 5 minutes



For in vitro diagnostic use. For use in employment and insurance testing.

T-Cube® Oral Fluid Drug Test

LIMIT WORKPLACE SAFETY CONCERNS

With numerous oral fluid drug test devices on the market, it is important that you select the one best suited for your particular setting and needs. The T-Cube® oral fluid drug test is intended for employment and insurance testing, and offers fast and convenient oral fluid detection for multiple drug assays. Oral fluid drug screening simplifies collection processes and protects against specimen tampering—allowing you to make informed decisions about substance abuse.

AVAILABLE DRUGS

DRUG	CALIBRATOR	CUT-OFF LEVEL (NG/ML)
Amphetamine (AMP)	D-Amphetamine	50
Barbiturates (BAR)	Secobarbital	20
Cocaine (COC)	Cocaine	20
Marijuana (THC)	Δ 9-THC	40
Methadone (MTD)	Methadone	30
Methamphetamine (MET)	D-Methamphetamine	50
Methylenedioxymethamphetamine (MDMA)	3,4-Methylenedioxymethamphetamine	50
Opiates (OPI)	Morphine	40
Oxycodone (OXY)	Oxycodone	20
Phencyclidine (PCP)	Phencyclidine	10

SIMPLE COLLECTION AND TESTING PROCEDURE

T-Cube® Device Components

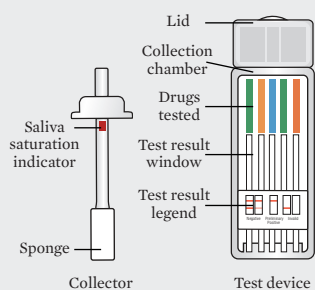

1 Put collector sponge on tongue or near cheek to collect oral fluid for about 3 minutes (until saturation indicator strip appears red)

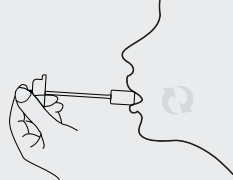

2 Open the test cube and place the saturated collector inside. Press firmly until it reaches the bottom. Close the test tube lid. Keep cube upright on a flat surface.

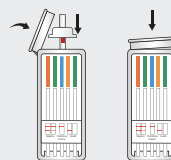

3 Interpret drug test results at 5 minutes. Do not read after 5 minutes.

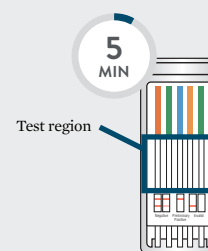

PRODUCT PROCEDURE NOTE: Refer to product insert for complete instructions, limitations, and warnings. For *in vitro* diagnostic use. For use in employment and insurance testing. The assay provides a qualitative, preliminary test result. A more specific analytical method must be used in order to obtain a confirmed result. Gas chromatography-mass spectrometry (GC-MS) or liquid chromatography-tandem mass spectrometry (LC-MS/MS) are preferred confirmatory methods. Professional judgment should be applied to any drug test result, particularly when preliminary results are positive.

TO LEARN MORE, CALL 800-340-4029
OR VISIT [ABBOTT.COM/TOXICOLOGY](https://www.abbott.com/toxicology)